

Introduction

Congratulations on your purchase of the SOS PRO from StainOut System! The SOS PRO is designed to give superior water removal performance when used with portable or truck mounted extractors. Years of experience, engineering, and planning have gone into the design and manufacturing of the SOS PRO. We take a great deal of pride in the SOS PRO; our goal is no less than your complete satisfaction.

FAQs

Q: How much does the SOS PRO weigh?

A: The SOS PRO tool weighs 9 lbs.

Q: How much does the handle extend?

A: The handle extends from 24" - 38" from the ground.

Q: What are the dimensions of extracting surface?

A: The extracting surface is 16.5" x 9.5".

Q: What size hose cuffs are compatible with the SOS PRO?

A: You can use 1.5" or 2" hose cuffs with the SOS PRO.

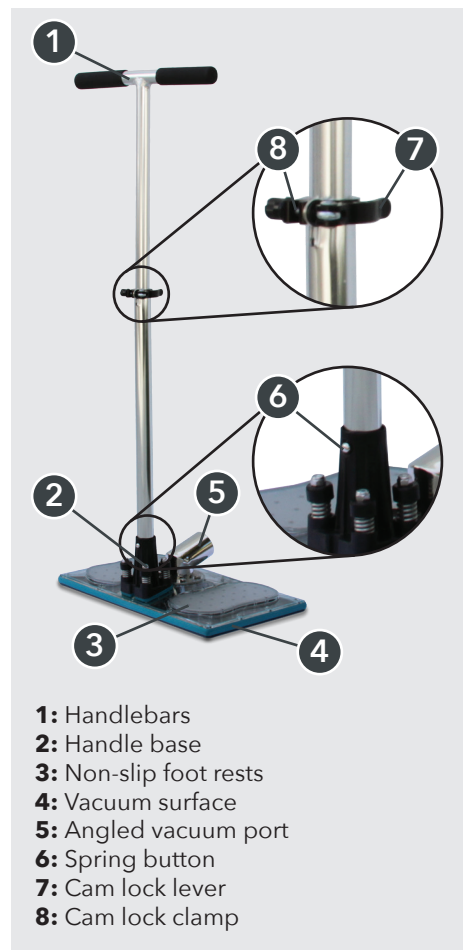

Assembling the SOS PRO

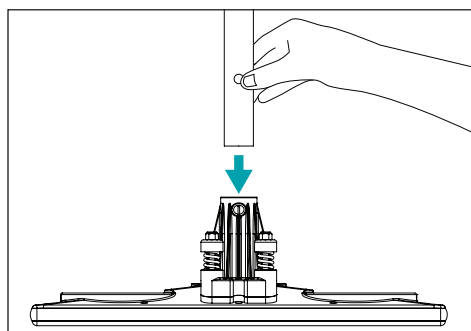

1. Press in the spring button and slide the handle into the handle base. Make sure the spring button lines up with the hole. It will snap into place.

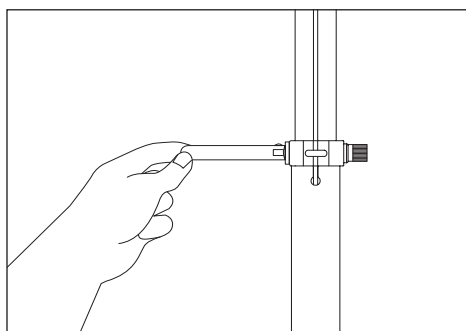

2. With the handle in place, pull the cam lock lever outward to loosen the clamp. Slide the handle up to desired height and press the lever back inward to tighten.

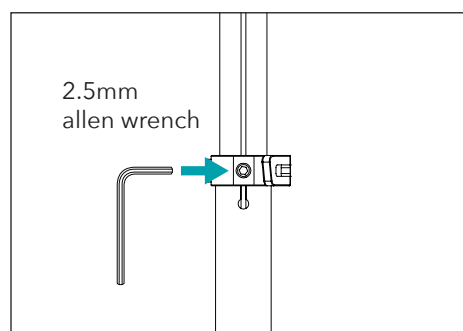

OPTIONAL: To ensure the handle will not move, tighten the set screw into the handle.

Using the SOS PRO

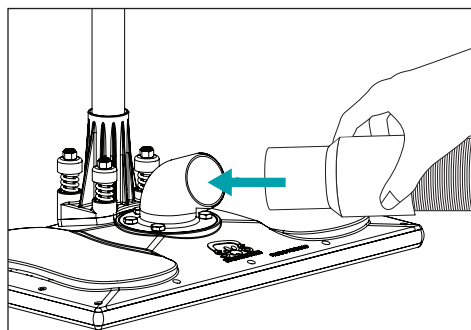

1. Connect vacuum hose from a portable or truck-mounted extractor. 2" cuffs will slide over the vacuum port and 1.5" cuffs will slide inside.

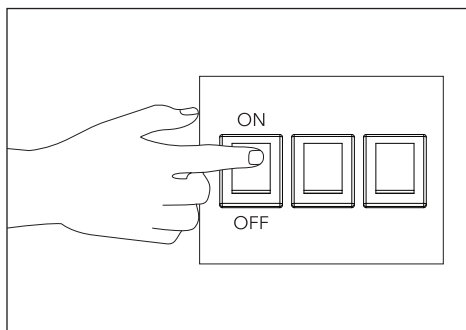

2. Turn the extractor ON.

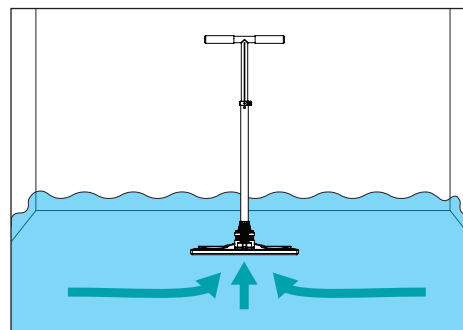

3. If there is standing water, place the SOS PRO in the center of the room to remove the standing water down to the carpet level.

Continued on other side. →



by StainOut System

User Manual

Using the SOS PRO (cont.)

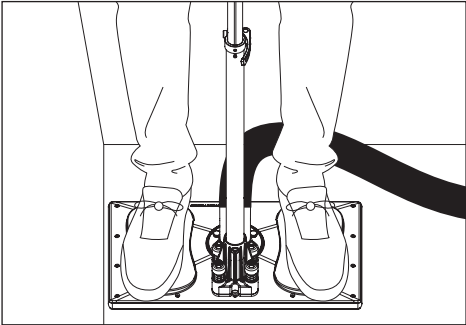

4. Place the SOS PRO in a starting point, usually a corner in the room and stand on it for about 5-30 seconds to extract water from the carpet and pad.

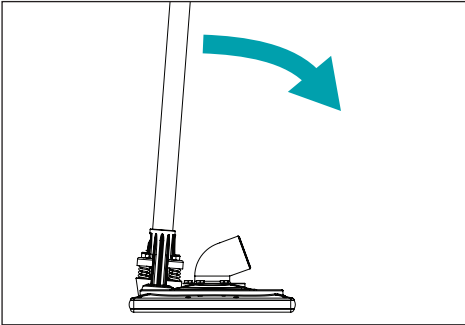

5. When you're ready to move to a new position, pull the handle back to release suction. Move the SOS PRO to a position that is directly adjacent to, but not overlapping, the previous extraction position.

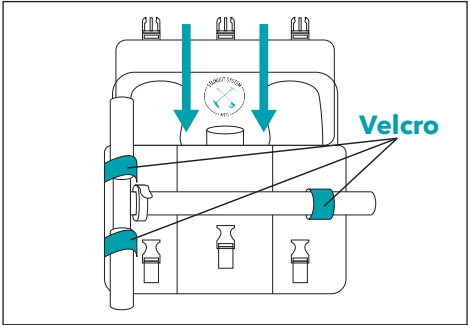

6. After you have covered the entire extraction area, test the carpet to see if further extraction is required. When you are finished using the SOS PRO, store it in the included travel bag as shown above.

Parts List

Item #	Part #	Description	Qty.
1	41-001	nut, lock, 1/4-20, nylon insert, s/s	4
2	21-003	spring cap, large	4
3	42-004	spring	4
4	41-005	screw, 6-32 x 1/2" phil pan head, s/s	14
5	41-003	carriage bolt, 1/4-20 x 3", s/s	2
6	42-003	yoke flange plate, large	1
7	21-002	bottom, large	1
8	22-001	seal, large	1
9	42-001	vac flange plate, large	1
10	41-006	carriage bolt, 1/4-20 x 2-3/4", s/s	2
11	21-001	top, large	1
12	42-002	vac tube, large	1
13	41-004	bolt, 1/4-20 x 3/4" hex head, s/s	5
14	22-002	vent gasket, large	1
15	21-004	yoke, large	1
16	42-005	handle	1
17	14-001	travel bag	1

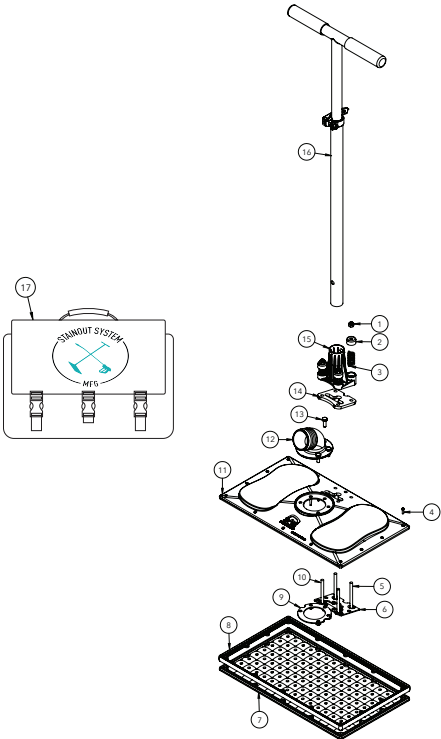

Warranty

Your SOS PRO is designed to give you years of reliable service.

If you are unable to determine the cause or solution to a problem contact your distributor or StainOut System for assistance.

StainOut System warrants the SOS PRO to be free from defects in material or workmanship for two years from the date of purchase.

During the warranty period, StainOut System will, at its option repair or replace components which prove to be defective. This warranty does not provide for replacement of complete units due to defective components. Any costs for transportation or related service labor are not covered in this warranty. Replacement parts are warranted only for the remainder of the original warranty period.

This warranty shall not apply to defects resulting from improper operation, lack of maintenance, unauthorized modification, chemical incompatibility, misuse, abuse or exposure to freezing temperature conditions. It does not apply to items which require replacement as a result of ordinary usage. To obtain warranty service for the SOS PRO, contact your distributor or StainOut System. If the tool must be returned to StainOut System or an authorized service center, the purchaser shall prepay shipping charges for products returned for warranty service. No returned items will be accepted by StainOut System without prior authorization. All returns must have a return authorization number, issued by StainOut System, clearly marked on the exterior of the package.

StainOut System makes no other warranty either expressed or implied with respect to this product.

The remedies provided herein are the purchaser's sole and exclusive remedies. In no event shall StainOut System be liable for any direct, indirect, special, incidental or consequential damages.

This warranty gives you specific legal rights. You may also have other rights which vary from jurisdiction to jurisdiction.

